

Cod. E20001II



Standard and Approvals

- Switch according to IEC/EN 60947-3
- Certified UL60947-4-1A and CAN/CSA C22.2 No. 60947-4-1-07
- Suitable as Manual Motor Controller



Contact block



Contact travel

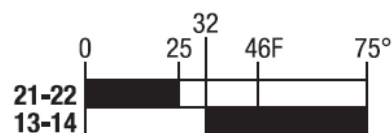

■ Contacts closed □ Contacts opened

Characteristics

- Thermoplastic body and metal head
- IP66 protection degree
- 1NO+1NC slow action contact block
- Contact block with positive opening
- 2 Pg13,5 cable entry

Drive cam operating parameters

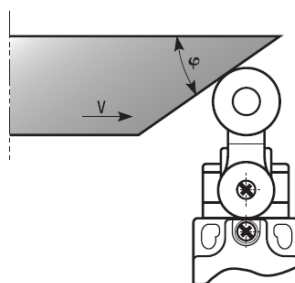

φ	V max (m/s)
30°	1,5
45°	1
60°	0,75
60-90°	0,25

Drive forces	
Minimum command force	15 Ncm
Minimum forced opening force	35 Ncm

Dimension

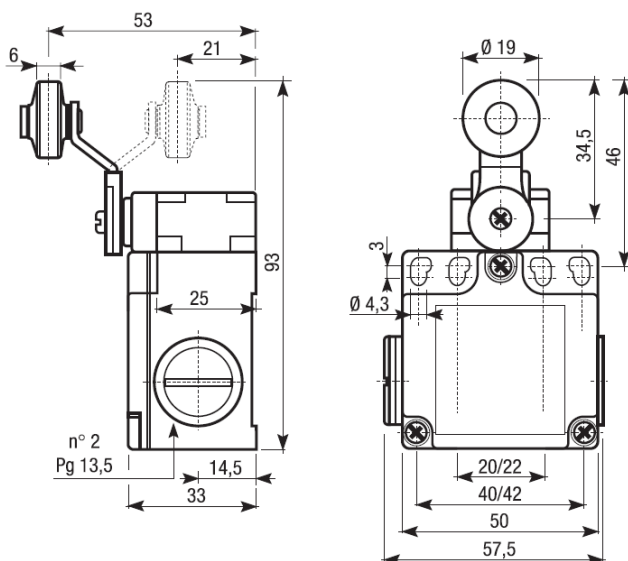

Cable Input/Output

2 on the sides



Actuator



Cod. E20001II

Technical data

				TYPE	E100 / E200 / E300 / E400
Maximum operating frequency				operat./hour ¹	3600
Insulation resistance			500 V DC	MΩ	100
Dielectric strenght			50/60 Hz for 1'	V AC	2500 ²
Rated insulation voltage	Ui	IEC947-5-1		V AC	500
Rated thermal current	Ithe	IEC947-5-1		A	10
Rated operating current	Category AC15 A300	IEC947-5-1/EN60947-5-1	24V	A	10
			125V	A	6
			230 V	A	6
			400 V	A	3
Contact resistance		IEC255-7 cat.3	initial value	mΩ	25
Short circuit protective devices	IEC269 (IEC947-5-1)				
	fuse type gL or gG			A	10
Rated conditionals short circuit current		IEC947-5-1		A	1000
Pollution degree		IEC947-5-1		A	3
Protection degree		EN 60529			IP66
Protection against electric shock			plastic	class	II
			metal	class	I
Vibration resistance		IEC68-2-6	mm		0,35 ± 15% (10 ÷ 55 Hz ± 1 Hz)
Shock resistance		IEC68-2-27	11ms	g	30
Mechanical life				cycles	20.000.000
Electric life	at 250V AC 6A with resistance load cosφ=1			cycles	500.000
	at 250V AC 6A with inductive load cosφ=0,4			cycles	500.000
				cycles	
Distance between contacts	Snap action type			mm	2x1,25
	Low action type			mm	2x2
Terminals	Type				Screw with combined notch and retractable plate (notch Ph, Size 1)
	Screw			M	3,5
	Protection degree				IP20
	Material				Steel class 8,8 / Galvanized
	Max screw tightening torque				120 (12,24)
	Max connecting capacity	rigid cable	mm ²		2x1,5
		flexible cable	mm ²		2x1,5
Terminal numbering					In accordance with EN50013
Air ambient temperature	operational			°C	-35 ÷ +85 (without formation of ice)
	operational				95% max

¹ One operation cycle means two movements, one to close and one to open as required by EN 60947-5.

² Between terminals of the same polarity; between terminals with different polarity; between live mechanical parts and ground; between live mechanical parts and non-current-carrying metal parts.