

**Cod. E10000IM**



### Standard and Approvals

- Switch according to IEC/EN 60947-3
- Certified UL60947-4-1A and CAN/CSA C22.2 No. 60947-4-1-07
- Suitable as Manual Motor Controller



### Contact block

1NO+1NC snap action

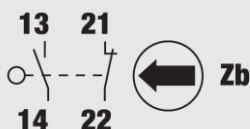

### Contact travel

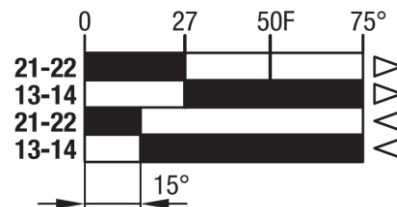

■ Contacts closed □ Contacts opened

### Characteristics

- Metal head and thermoplastic body
- IP66 protection degree
- 1NO+1NC snap action contact block
- Contact block with positive opening
- 1 cable entry
- Pg 13,5 thread

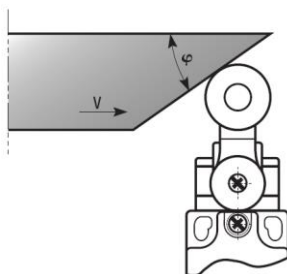

$\varphi$	V max (m/s)
30°	1,5
45°	1
60°	0,75
60-90°	0,25

### Drive forces

Minimum command force	15 Ncm
Minimum forced opening force	35 Ncm

### Dimension

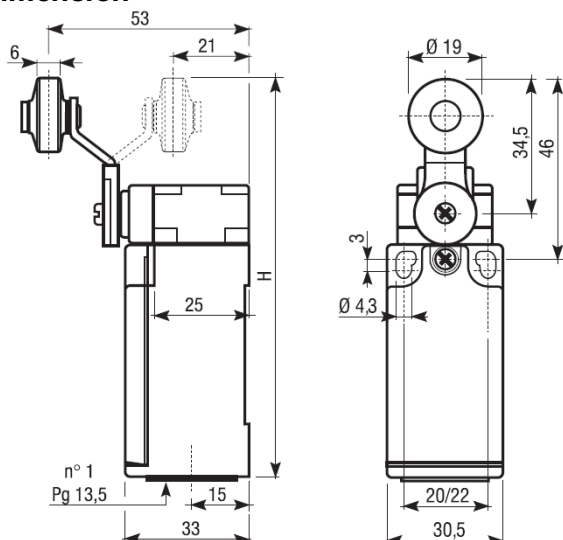

### Cable Input/Output

1 on the bottom



### Actuator



Thermoplastic roller lever

### Cod. E10000IM

#### Technical data

		TYPE	E100 / E200 / E300 / E400			
Maximum operating frequency		operat./hour <sup>1</sup>	3600			
Insulation resistance		500 V DC MΩ	100			
Dielectric strenght		50/60 Hz for 1'	2500 <sup>2</sup>			
Rated insulation voltage	Ui	IEC947-5-1	V AC	500		
Rated thermal current	Ithe	IEC947-5-1	A	10		
Rated operating current	Category AC15 A300	le	IEC947-5-1/EN60947-5-1	24V	A	10
				125V	A	6
				230 V	A	6
				400 V	A	3
Contact resistance		IEC255-7 cat.3	initial value	mΩ	25	
Short circuit protective devices		IEC269 (IEC947-5-1)				
		fuse type gL or gG		A	10	
Rated conditionals short circuit current		IEC947-5-1		A	1000	
Pollution degree		IEC947-5-1		A	3	
Protection degree		EN 60529			IP66	
Protection against electric shock			plastic	class	II	
			metal	class	I	
Vibration resistance		IEC68-2-6	mm		0,35 ± 15% (10 ÷ 55 Hz ± 1 Hz)	
Shock resistance		IEC68-2-27	11ms	g	30	
Mechanical life				cycles	20.000.000	
Electric life		at 250V AC 6A with resistance				
		load cosφ=1		cycles	500.000	
		at 250V AC 6A with inductive				
	load cosφ=0,4		cycles	500.000		
Distance between contacts		Snap action type		mm	2x1,25	
		Low action type		mm	2x2	
Terminals		Type			Screw with combined notch and retractable plate (notch Ph, Size 1)	
		Screw		M	3,5	
		Protection degree			IP20	
		Material			Steel class 8,8 / Galvanized	
		Max screw tightening torque			120 (12,24)	
		Max connecting capacity	rigid cable	mm <sup>2</sup>	2x1,5	
	flexible cable		mm <sup>2</sup>	2x1,5		
Terminal numbering					In accordance with EN50013	
Air ambient temperature		operational		°C	-35 ÷ +85 (without formation of ice)	
Relative umidity		operational			95% max	

<sup>1</sup> One operation cycle means two movements, one to close and one to open as required by EN 60947-5.

<sup>2</sup> Between terminals of the same polarity; between terminals with different polarity; between live mechanical parts and ground; between live mechanical parts and non-current-carrying metal parts.