

Cod. E1000FI



(purely indicative photo)

Standard and approvals

- Certified according to IEC/EN 60947-1
- Certified according to UL file E72861
- Certified according to CSA file 026716-0-000



Technical characteristics

- Thermoplastic body and metal head
- IP66 protection degree
- Thermoplastic roller variable length lever actuator
- 1NO+1NC snap action contact block
- Contact block with positive opening
- 1 cable entry
- Pg 13,5 thread
- Weight: 0,150 Kg

Contact travel

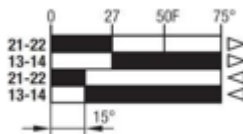

Contact block

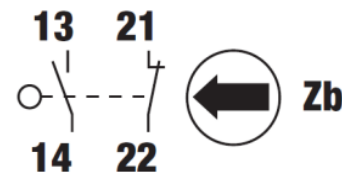

Dimensions

measurements in mm

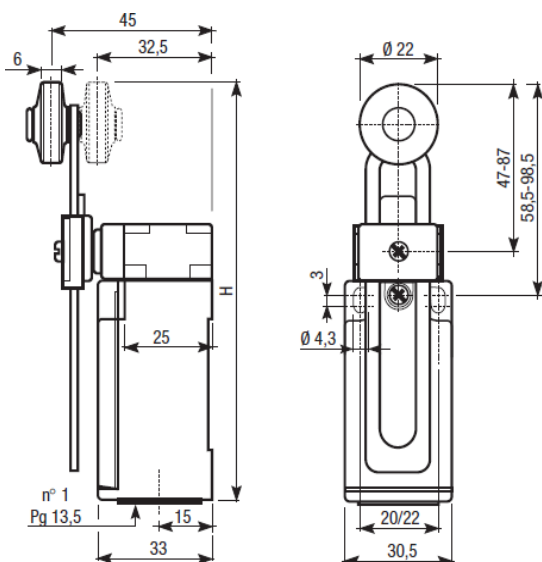

H=116÷156 mm

■ Contacts closed □ Contacts opened

Position switches

E100 Series – datasheet



Bremas Ersce SpA
 Via castellazzo 9 – 20040 Cambiago (MI)
 Tel +39 02 95651611 Fax +39 02 95651639
www.bremas.it info@bremas.it
 ISO 9001 Certified Quality System

Cod. E1000FI

Insulation resistance		500VDC	MΩ	100	
Dielectric strength		50/60 Hz for 1' *	VAC	2500	
Rated insulation voltage	Ui	IEC947-5-1	VAC	500	
Rated thermal current	Ithe	IEC947-5-1	A	10	
Rated operating current		IEC/EN 947-5-1			
	Category AC15	le	24V	A	10
	A300		125V	A	6
			230V	A	6
			400V	A	3
Contact resistance	IEC255-7 cat.3	Initial value	MΩ	25	
Short circuit protective devices	IEC269 (IEC947-5-1)	gl or gG type fuse	A	10	
Rated conditionals short circuit current	IEC947-5-1		A	1000	
Pollution degree	IEC947-5-1			3	
Protection degree	EN60529			IP66	
Protection against electric shock		plastic	class	II	
		metal	class	I	
Vibration resistance	IEC68-2-6	mm		0,35±15%	
Shock resistance	IEC68-2-27	11 ms	g	10+55 Hz ± 1 Hz	
Mechanical life			cycles	30	
				15000000	
Electrical life	at 250 V AC 6A with resistance load cosφ=1		cycles	500000	
	at 250 V AC 6A with inductive load cosφ=0,4		cycles	500000	
Distance between contacts	snap action type		mm	2x1,2	
	slow action type		mm	2x2	
Terminals	type			Screw with combined notch and retravtable plate (notch Ph. size 1)	
	screw		M	3,5	
	protection degree			IP20	
	material			Steel class 8,8/Galvanized	
	max. screw tightening torque		cNm (Kg cm)	120 (12,24)	
	max. connecting capacity	rigid cable	mm ²	2x1,5	
		flexible cable	mm ²	2x1,5	
	with prod terminal			in accordance EN50013	
Air ambient temperature		operational	°C	-35+85 (withou of ice)	
Relative humidity		operational		95% max	

* Between terminals of the same polarity; between terminals with different polarity; between live mechanical parts and ground; between live mechanical parts and non-current-carrying metal parts