

Cod. DS0633RQL6 69



Technical characteristics: Body

- Disconnect switch 3P
- IP20 protection degree
- Rating operational current: 63A
- Rating thermal current: 63A
- Rating insulation voltage: 690V
- Rear Mounting
- Fixing with 2 screw at 28mm vertical
- Switching angle: 90°
- Positive opening double break contacts, made of silver and alloy.
- Self-extinguishing class V0



Technical characteristics: Plate and knob

- Yellow plate 67x67mm and red padlockable knob (max. 3 padlocks)
- Protection degree IP66
- Fixing with 2 screw at 28mm vertical

Plate and position

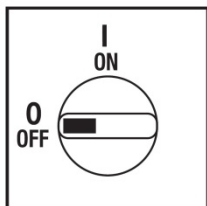

Electrical scheme

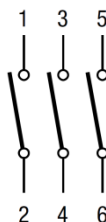

Cod. DS0633RQL6 69

Dimensions

measures in mm (in)

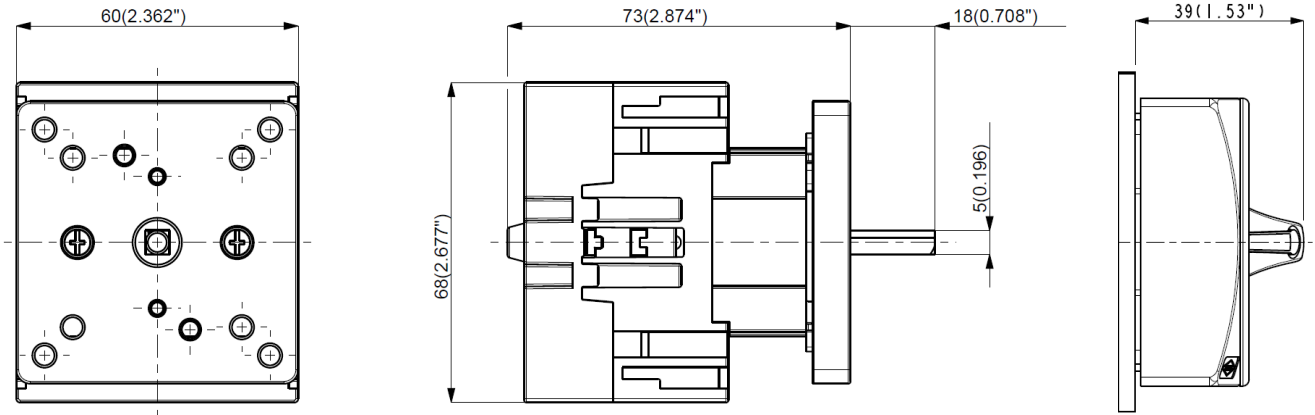

Drilling templates

measures in mm (in)

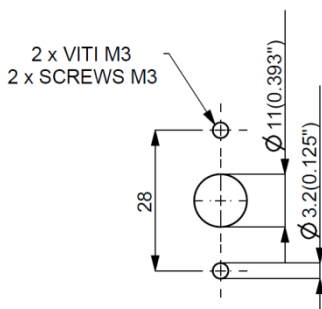

Cod. DS0633RQL6 69

			DS063	
Technical data IEC 947-3 EN 60947-3				
Rated insulation voltage	Ui	V	690	
Rated operating voltage	Ue	V	690	
Rated impulse withstand voltage	Uimp	kV	6	
Rated thermal current for open switch	Ith	A	63	
Rated thermal current for enclosed switch	Ithe	A	63	
Rated operation frequency		Hz	50	
Power dissipation for each pole		W	-	
Rated operating current				
AC-21A Switching resistive loads, including moderate overloads	690V	Ie	A	63
AC-22A Switching of mixed resistive and inductive loads, including moderate overloads	690V	Ie	A	63
Rated operating power				
AC-23A Switching of motor loads or other highly inductive loads 3 phase - 3 pole	400V	Kw (A)	25 (47)	
	690V	Kw (A)	18,5 (19)	
AC-3 Squirrel cage motors: starting, switching off motors during running 3 phase - 3 pole	400V	Kw (A)	18,5 (33)	
	690V	Kw (A)	15 (16)	
Rated breaking capability in AC-23A (cos φ=0,45)	400V	A	376	
	690V	A	-	
Short circuit protection				
Rated short time withstand current	Icw	A	1500	
Rated short-circuit make capacity	Icm	A	2000	
Rated conditional short-circuit current		kA	15	
With fuses class gG	500V	A	63	
Mechanical life (120 cycles/hour)	Mil.Man		2	
Connecting capability with flexible wires	Min-Max	mm ²	6-35	
Connecting capability with solid wires	Min-Max	mm ²	10-50	
Terminal screw			M5	
Screw tightening torque		Nm	2,8	
Technical data UL/CSA				
Rated operating voltage	Ue	V	600	
General use current	600Vac	Ie	A	80
Rated operating power				
1 phase - 2 pole	120V	Hp (A)	3/34	
	240V	Hp (A)	5/28	
3 phase - 3 pole	200V	Hp (A)	10/32	
	240V	Hp (A)	20/54	
	480V	Hp (A)	25/34	
	600V	Hp (A)	30/32	
Line protection fuses (Class J, 600Vac)		A	225	
Short Circuit Rating@600Vac		kA	10	
Mechanical characteristics				
Connecting capability with flexible wires	Min-Max	AWG	10/01	
Connecting capability with solid wires	Min-Max	AWG	08/01	
Screw tightening torque		ib.in	24	
Protection degree IEC 529 EN 60529				
Terminals			IP20	
Plate and knob			IP66	
Ambient conditions				
Operating ambient temperature		°C	-25 ÷ +70	
Storage ambient temprature		°C	-40 ÷ +85	
Withstand to constant humid according to IEC 60068			sec. IEC 60068-2-78	
Withstand to cyclic humid according to IEC 60068			sec. IEC 60068-2-30	
Auxiliary contacts				
			XC012AB XC012CB	
Rated insulation voltage	Ui	V	690	
Rated thermal current for open switch	Ith	A	12	
AC-15 Control of a.c electromagnetic loads	230V	A	6	

Standard

IEC/EN 60947-3; UL508

Approvals

