

Cod. DS0504BAL6



Standard and Approvals

- Switch according to IEC/EN 60947-3
- Certified UL60947-4-1A and CAN/CSA C22.2 No. 60947-4-1-07
- Suitable as Manual Motor Controller



Technical characteristics: Body

- Disconnect switch 3+N
- IP20 protection degree
- Rating operational current Ie: 50A (AC-21A)
- Rating thermal current Ith: 50A
- Rating insulation voltage: 690V
- Base Mounting
- Fixing:
 - with screws
 - Din rail
- Switching angle: 90°
- Positive opening double break contacts, silver alloy made.
- Self-extinguishing class V2



Technical characteristics: Plate and knob

- Yellow plate 67x67mm and red padlockable knob (max. 3 padlocks)
- Protection degree IP66
- Fixing with 2 screw at 28mm (1,10") horizontal or 2 screw at 32mm (1,26") vertical

Plate and position

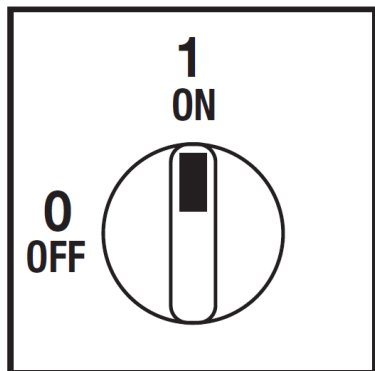

Electrical scheme

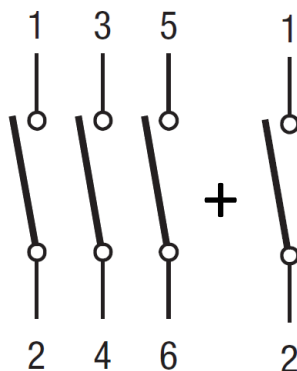

Cod. DS0504BAL6

measures in mm (in)

Dimensions

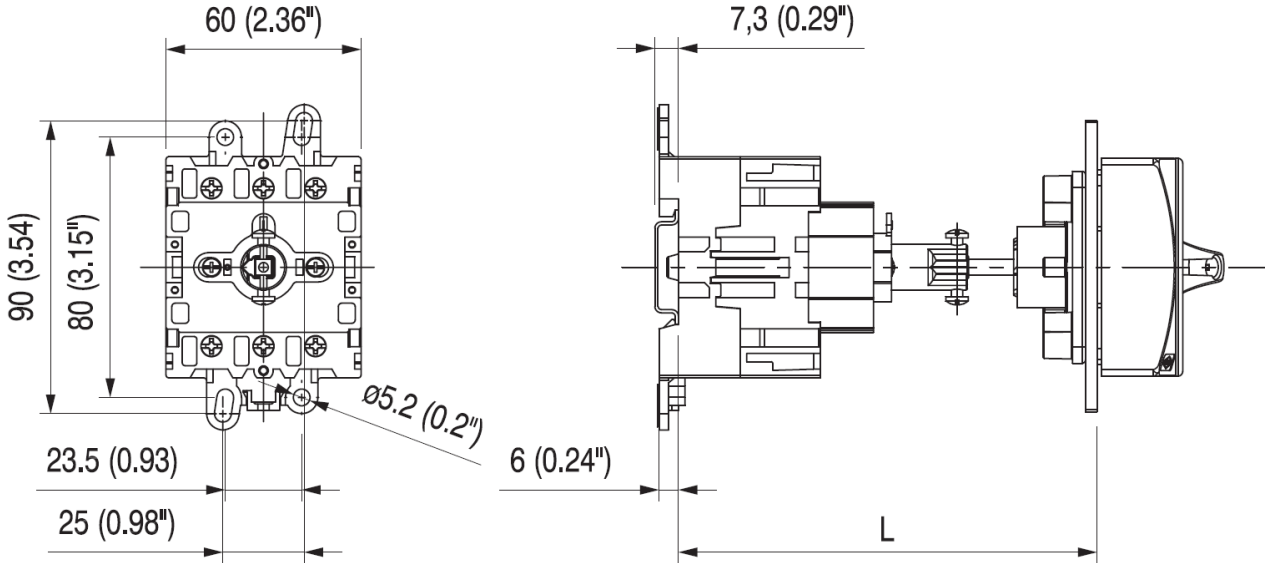

Overall length (min-max)**
for different shaft length (L1):

L1		
175*	L (mm)	114 - 258
6.89*	L (in)	4.49" - 10.15"
300	L (mm)	114 - 383
11.81	L (in)	4.49" - 15.07"
500	L (mm)	114 - 258
19.68	L (in)	4.49" - 22.95"

* Standard shaft, bundled

** Minimum length obtainable by cutting the shaft.

Drilling templates

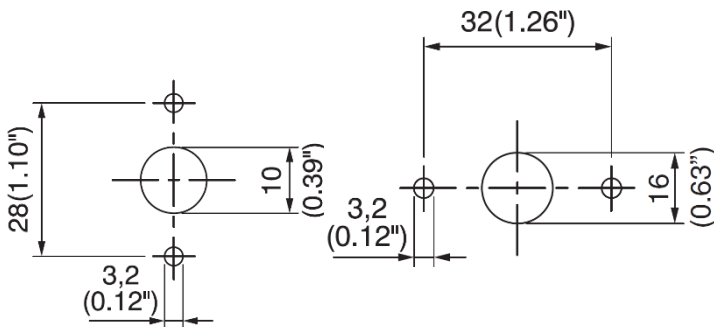
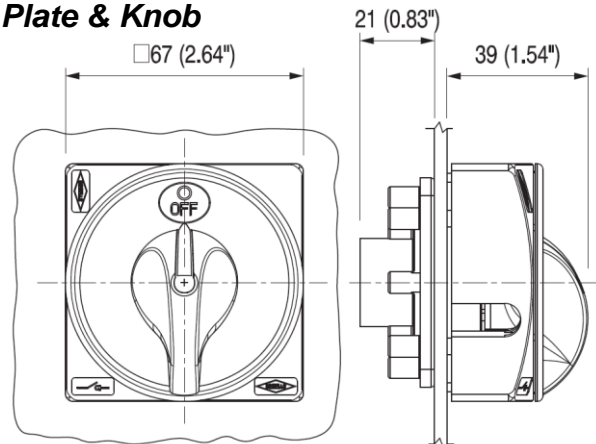

Plate & Knob



Cod. DS0504BAL6

Technical data IEC 947-3 EN 60947-3				
Rated insulation voltage		Ui	V	690
Rated operating voltage		Ue	V	690
Rated impulse withstand voltage		Uimp	kV	6
Rated thermal current for open switch		Ith	A	50
Rated thermal current for enclosed switch		Ithe	A	50
Rated operation frequency			Hz	50
Power dissipation for each pole			W	4,6
Rated operating current Ie				
AC-21A Switching resistive loads, including moderate overloads	690V	Ie	A	50
AC-22A Switching of mixed resistive and inductive loads, including moderate overloads	690V	Ie	A	50
Rated operating power				
AC-23A Switching of motor loads or other highly inductive loads	400V	Kw (A)		22 (40)
	690V	Kw (A)		18,5 (19)
AC-3 Squirrel cage motors: starting, switching off motors during running	400V	Kw (A)		18,5 (33)
	690V	Kw (A)		15 (16)
Rated breaking capability in category AC-23A (cos φ=0,45)	400V	A		320
	690V	A		-
Short circuit protection				
Rated short time withstand current (1s)		Icw	A	1500
Rated short-circuit make capacity		Icm	A	2000
Rated conditional short-circuit current			kA	15
With fuses class gG	500V	A		63
Technical data UL/CSA (sec. UL508)				
General use voltage		Ue	V	600
General use current	600Vac	Ie	A	80
Rated operating power				
1 phase - 2 pole	120V	Hp/FLA		3/34
	240V	Hp/FLA		3/17
3 phase - 3 pole	200V	Hp/FLA		7,5/25,3
	240V	Hp/FLA		15/42
	480V	Hp/FLA		20/27
	600V	Hp/FLA		30/32
Line protection fuses (DS size 1: Class RK5, 600Vac, 200kA A.I.C.), (DS size 2: Class J, 600Vac)			A	225
Short Circuit Rating@600Vac			kA	10
Mechanical characteristics				
Mechanical life (120 cycles/hour)		Operations x10 ⁶		0,1
Connecting capability with flexible wires		Min-Max	mm ²	6-35
Connecting capability with solid wires		Min-Max	mm ²	10-50
Connecting capability with flexible wires		Min-Max	AWG	10/01
Connecting capability with solid wires		Min-Max	AWG	08/01
Terminal screw			M5	
Screw tightening torque			Nm	2,8
			lbf-in	24
Protection degree IEC 529 EN 60529				
Terminals				IP20
Handles				IP66
Ambient conditions				
Operational ambient temperature			°C	-25 ÷ +70
Storage ambient temperature			°C	-40 ÷ +85
Withstand to constant humid according to IEC 60068				sec. IEC 60068-2-78
Withstand to cycling humid according to IEC 60069				90% at 55°C