

Cod. DS0323RRL6



Technical characteristics: Body

- Switch disconnect 3 pole
- IP20 Protection degree
- Rated operational current I_e : 32A
- Rated thermal current I_{th} : 32A
- Rated insulation voltages U_i : 800V
- Rear Mounting
- Fixing with 2 screw at 28mm vertical
- Switching angle: 90°
- Class V2 self-extinguishing thermoplastic housing
- Positive opening double break contacts



Technical characteristics: Plate and knob

- Yellow plate 67x67mm and red padlockable knob (max. 3 padlocks)
- Protection degree IP66
- Fixing with 2 screw at 28mm vertical

Plate and position

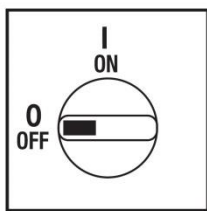

Electrical scheme

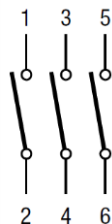

Cod. DS0323RRL6

Dimensions

measures in mm (in)

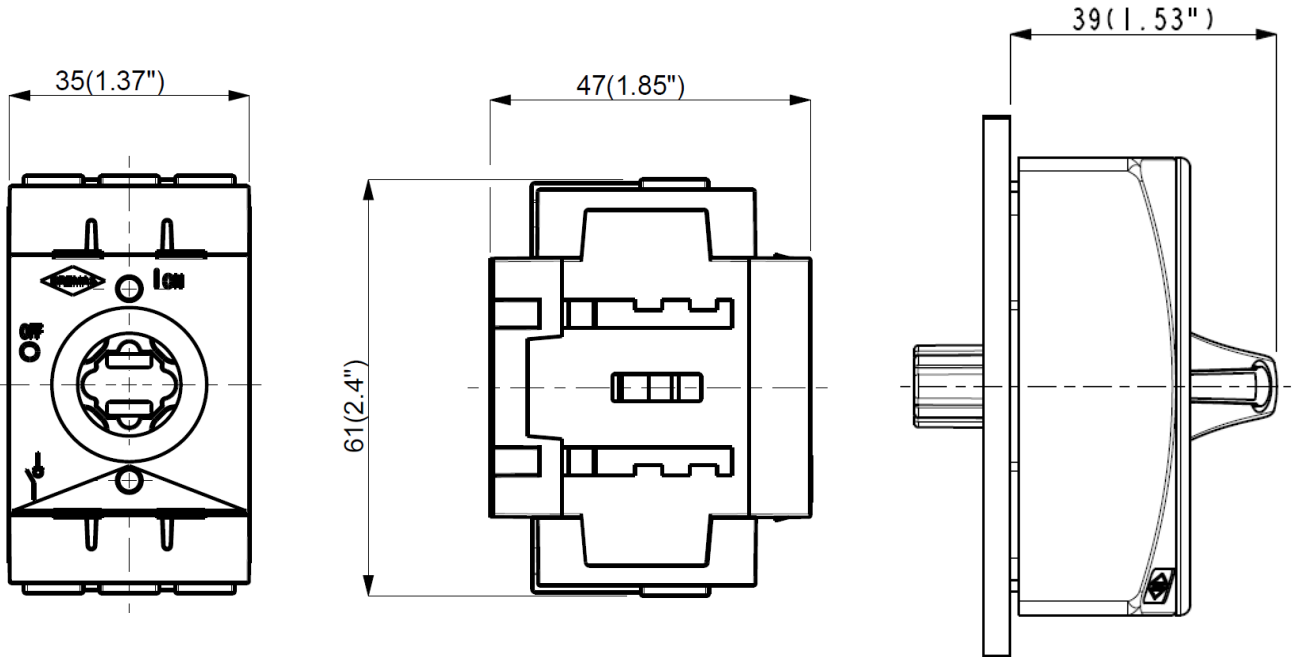

Drilling templates

measures in mm (in)

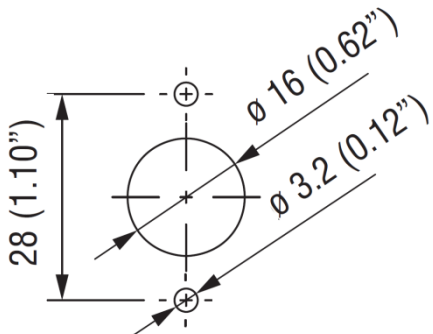

Cod. DS0323RRL6

			DS032	
Technical data IEC 947-3 EN 60947-3				
Rated insulation voltage	Ui	V	800	
Rated operational voltage	Ue	V	800	
Rated impulse withstand voltage	Uimp	kV	8	
Rated thermal current for open switch	Ith	A	32	
Rated thermal current for enclosed switch	Ithe	A	32	
Rated operational frequency		Hz	50/60	
Power dissipation for each pole		W	1,3	
Rated operational current				
AC-21A Switching resistive loads, including moderate overloads 3P/3P+N	690V	Ie	A	32
AC-22A Switching of mixed resistive and inductive loads, including moderate overloads 3P/3P+N	690V	Ie	A	32
Rated operational power				
AC-23A Switching of motor loads or other highly inductive loads 3 phase - 3 pole	400V	Kw (A)	11 (22)	
	690V	Kw (A)	11 (16)	
AC-3 Squirrel cage motors: starting, switching off motors during running 3 phase - 3 pole	400V	Kw (A)	7,5 (14)	
	690V	Kw (A)	7,5 (8)	
Rated breaking capability in AC-23A (cos φ=0,45)	400V	A	176	
	690V	A	128	
Short circuit protection				
Rated short time withstand current	Icw	A	400	
Rated short-circuit make capacity	Icm	A	750	
Rated conditional short-circuit current		kA	10	
With fuses class gG	500V	A	32	
Mechanical life (120 cycles/hour)	Mil.Man			
Connecting capability with flexible wires	Min-Max	mm ²	1,5-10	
Connecting capability with solid wires	Min-Max	mm ²	1,5-16	
Connection terminal screw dimensions			M4	
Screw tightening torque		Nm	1,7	
Technical data UL/CSA (sec. UL508)				
General use voltage	Ue	V	600	
General use current	600Vac	Ie	A	30
Rated operating power				
1 phase - 2 pole	120V	Hp/FLA	1,5/-	
	240V	Hp/FLA	3/-	
	200V	Hp/FLA	-/-	
3 phase - 3 pole	240V	Hp/FLA	7,5/22	
	480V	Hp/FLA	15/21	
	600V	Hp/FLA	20/22	
Line protection fuses (Class RK5, 600Vac, 200kA A.I.C.)		A	30	
Short Circuit Rating@600Vac		A	-	
		kA	5	
Auxiliary contacts designation			AC Voltage, "Heavy Pilot Duty" (A600)	
Mechanical characteristics				
Connecting capability with flexible wires	Min-Max	AWG	16/08	
Connecting capability with solid wires	Min-Max	AWG	16/06	
Screw tightening torque		ib.in	12	
Protection degree IEC 529 EN 60529				
Terminals			IP20	
Handles			IP66	
Ambient conditions				
Operational ambient temperature		°C	-25 ÷ +55	
Storage ambient temperature		°C	-25 ÷ +55	
Withstand to constant humid according to IEC 60068			sec. IEC 60068-2-78	
Withstand to cycling humid according to IEC 60069			sec. IEC 60068-2-30	
Auxiliary contacts				
DSC040NO_DSC040NC_				
Rated insulation voltage	Ui	V	800	
Rated thermal current for open switch	Ith	A	10	
AC-15 Control of a.c electromagnetic loads	230V	A	3	

Standard

IEC/EN 60947-3; UL508

Approvals

